

LOCATION MAP
NOT TO SCALE

NOTE:

- 1) Proposed 5'-0" Buffer (Setback) front property line.
- 2) Diagram: Cars turnaround to orient the vehicle toward the street:
 - In between two building (OPTION I)
 - In the rear yard (OPTION II)
- 3) The owner parking space #4 (OPTION I) will be regulated with a sign indicating the time period (7:00 pm to 9:00 am) during which it can be used for parking. This ensures that it does not obstruct vehicle so that it does not interfere with vehicles that are turning around to orient themselves toward the street.
- 4) Proposed suitable for landscaping area eleven (11) trees (T):
Pine, Upright White (Pinus Strobus Fastigiata) and/or Swiss Stone (Pinus cembra)

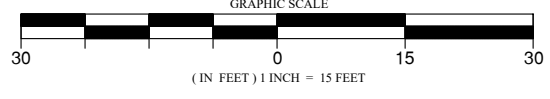

PARKING PLAN
SCALE: 1" = 15'-0"

Proposed grass with plantings in the 5' buffer area to absorb storm-water and place grass between garage and buffer area (**Question # 5**)

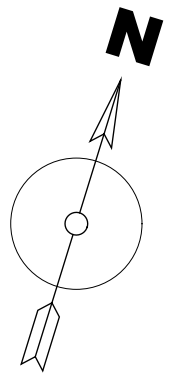

Proposed buffer area 5 feet between property line and new concrete in front of the garage (**Question # 3**)

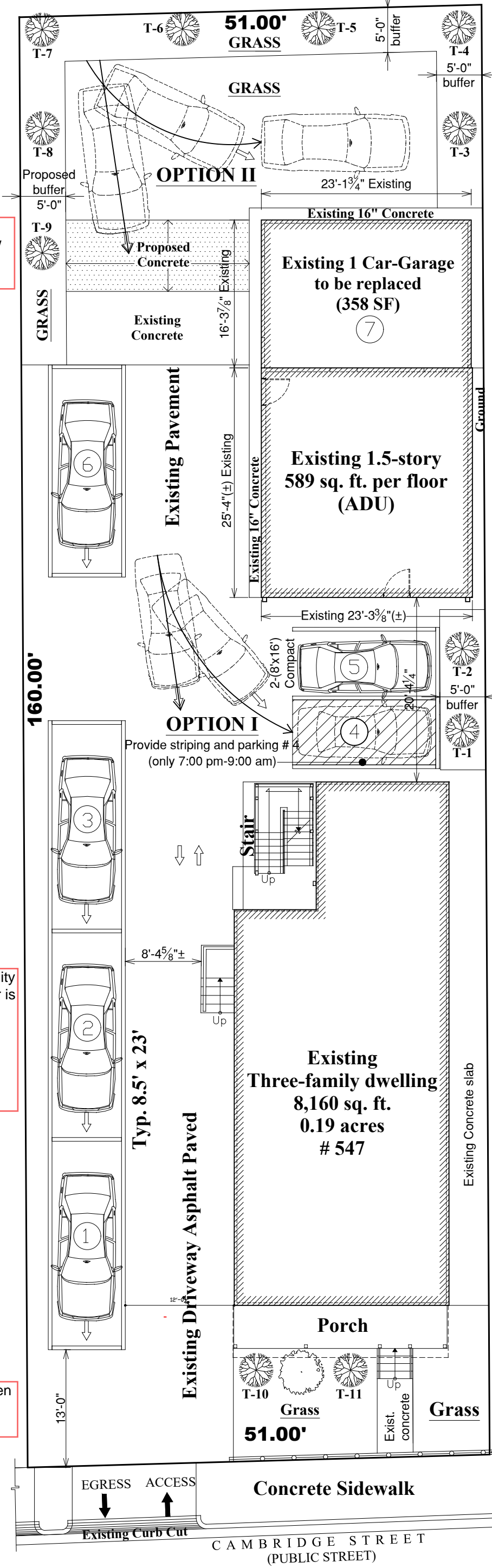

Planting added to the buffer area by the two compact spaces (**Question #6**)

This is pre-existing non-conformity parking spaces 1-3 and 5' buffer is not required. The **Option I & II** show how the cars pull into the driveway, turnaround, and then park in the spaces and to orient the vehicle toward the street (**Question # 4**)

Proposed more space between the front property line and the parking space (13'-0")

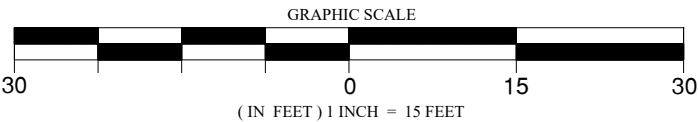

PARKING PLAN

SCALE: 1" = 15'-0"

NOTE:

- 1) Proposed 5'-0" Buffer (Setback) front property line.**
- 2) Diagram: Cars turnaround to orient the vehicle toward the street:**
 - In between two building (OPTION I)**
 - In the rear yard (OPTION II)**
- 3) The owner parking space #4 (OPTION I) will be regulated with a sign indicating the time period (7:00 pm to 9:00 am) during which it can be used for parking. This ensures that it does not obstruct vehicle so that it does not interfere with vehicles that are turning around to orient themselves toward the street.**
- 4) Proposed suitable for landscaping area eleven (11) trees (T):
Pine, Upright White (Pinus Strobus Fastigiata) and/or Swiss Stone (Pinus cembra)**